

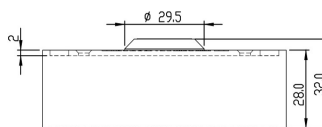
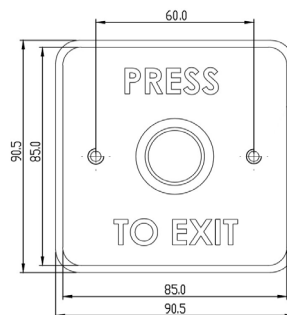
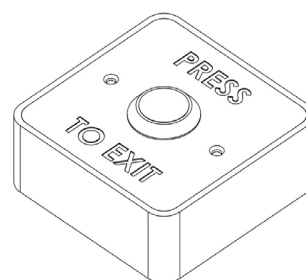

**REX220**

**REX220-2**

**REX120**

**REX120-2**
**MOMENTARY SWITCH**
**TECHNICAL SPECIFICATIONS:**

- Contacts: Double Pole N/O - N/C
- Output: 4Amp contact @ 30V AC/DC
- Wear resistant legend
- Security screws (allen key type)
- Internal use only
- Operating temperature -20° to +50°c

**FEATURES:**

- Momentary switch
- High impact plastic back box
- Can be surface or flush fitting
- Easy clean surface
- Ideal for general/sensitive areas
- Screw footprint for flush fitting onto standard back box

**FUNCTION:**

The button is designed to remove power from the circuit and turn the maglock off.

With this being a momentary product as soon as the button is released the power will return (unless a time delay has been added)



REX220	85x85x54 (mm)	PRESS TO EXIT	240g (Boxed)
REX220-2	85x85x54 (mm)	DOOR RELEASE	240g (Boxed)
REX120	85x39x28 (mm)	PRESS TO EXIT	128g (Boxed)
REX120-2	85x39x28 (mm)	DOOR RELEASE	128g (Boxed)

Other items in the range:

